

Radon Testing

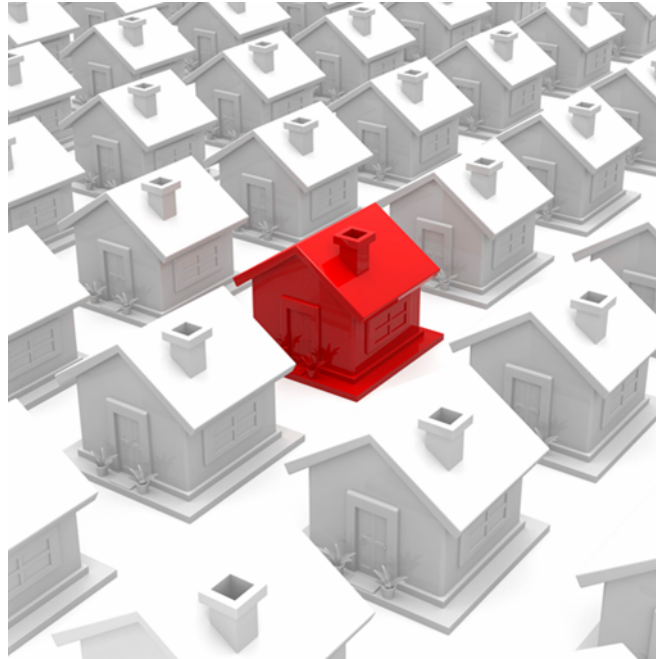

Twa-le Abrahamson-Swan
Spokane Tribal Air Quality Department
509-626-4403
twalea@spokanetribe.com

RADON: Spokane Reservation

- Reservation is rich in uranium deposits and has high radon potential (**Zone I**)
- Previous testing indicated high levels (30-40% homes higher than US Average)
- Some testing and mitigation efforts in the 80s

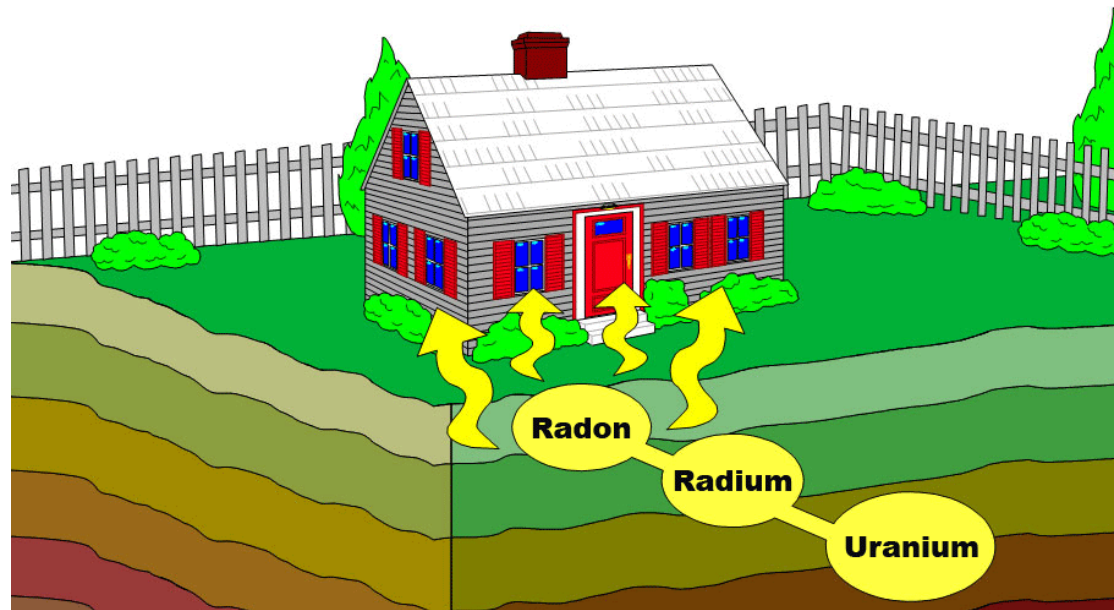

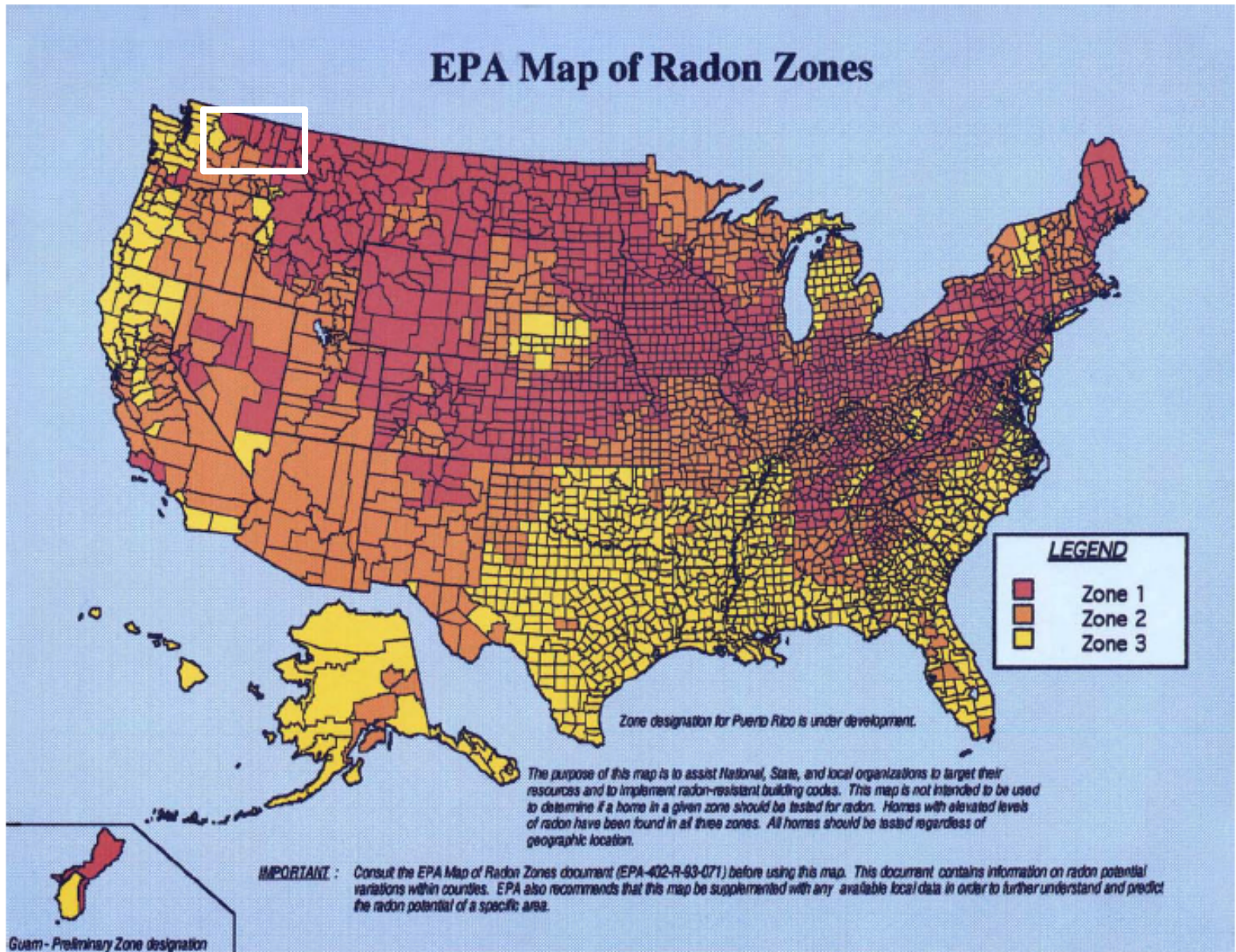

Radon “potential” Map





[HOME](#) > [Your Radon Levels](#) >

Radon Levels by State

 Above 4.0 pCi/L
  Between 2 and 4 pCi/L
  Less than 2.0 pCi/L

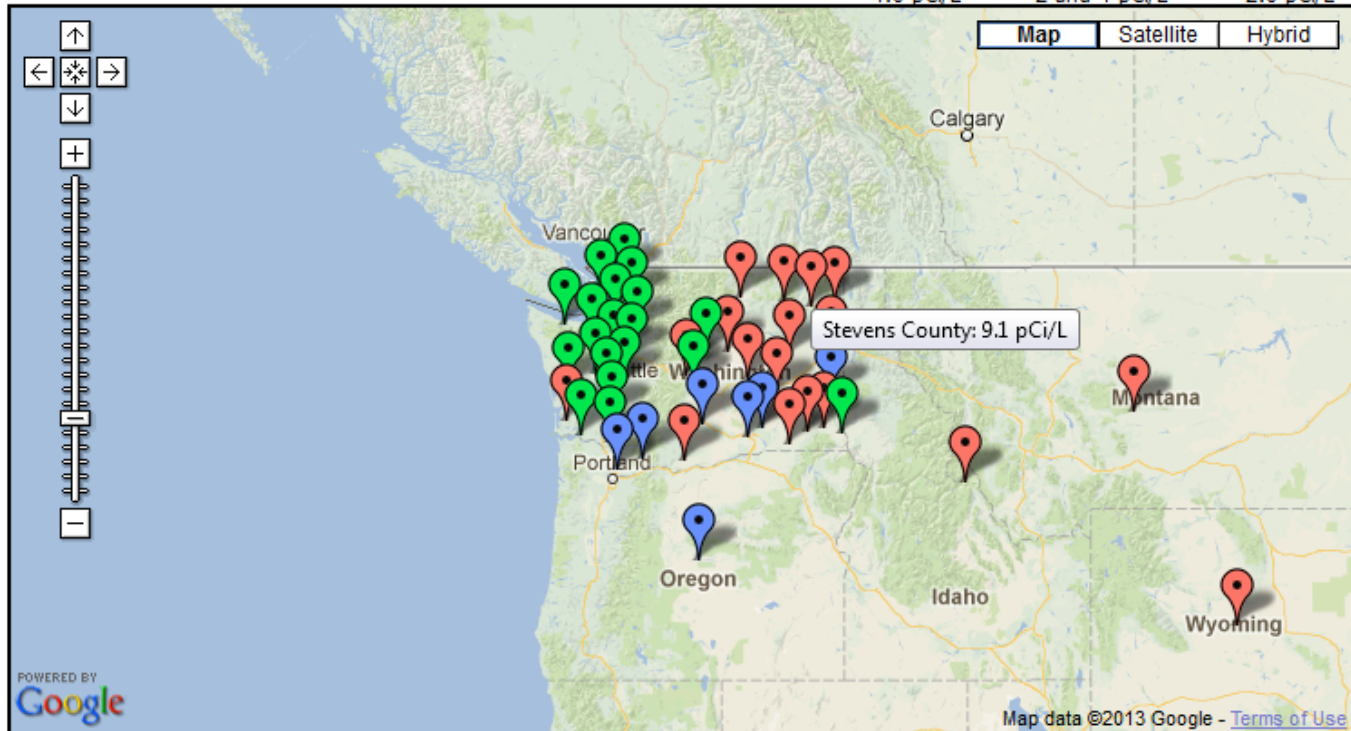

Mouse over the pointers for more information

The data presented above was collected from Air Chek, Inc., the US EPA, and various state and county health departments.

800-AIR-CHEK (800-247-2435) · Hours: **8:30-5:30** Eastern Time, Monday - Friday

Copyright © 2009 [Air Chek, Inc.](#) All rights reserved.

Where to start?

1. Test your own homes, offices, schools.
2. Standard Operating Procedures Available from many EPA sources (Radon, Tools for Schools)
3. Additional training?

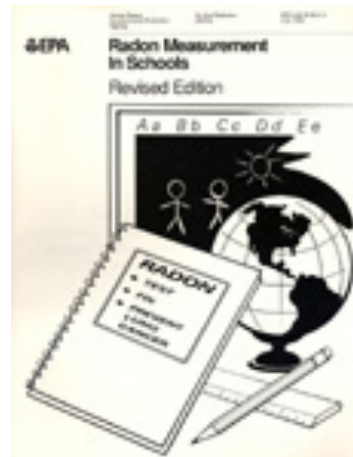

Radon Measurement Certification

- NOT required for Tribal Programs
- EPA *had* a National Radon Proficiency Program
 - Closed in 1998, “due to the Agency’s limited resources”
 - Recognized two non-federal radon proficiency programs:
 - The National Radon Safety Board (NSRB)
 - The National Environmental Health Association’s (NEHA) Radon Proficiency Program (NRPP)
- NEHA’s National Radon Proficiency Program
 - Residential Measurement Provider – qualified to place, retrieve, and interpret radon results
 - Entry level course (16 Hours)
 - Pass NRPP radon measurement exam
 - Application fee covers 2 years
 - Training: http://nrpp.info/entry_level.shtml
 - http://www.nrsb.org/course_meas_init.asp

Benefits of NEHA Certification

- Be recognized as a professional!
- ID Card
- Newsletters
- Information on educational programs and conferences
- Listed on the internet





Search for
 Certified . . . Measurement Professional
 Mitigation Professional
 Laboratory Services

About Radon Risk
 Case Studies
 Radon Testing Checklist
 How to Select a Professional
 Need a Speaker?



NRPP • National Radon Proficiency Program • NRPP

- About NRPP
- Certification
- Radon Training
- Radon Testing Devices
- Resources & Links
- Contact Us
- Home

NEHA-NRPP.org

Residential Measurement Providers Servicing Washington

- Recent News
- Find a Radon Professional
- Frequently Asked Questions
- Radon Publications
- Provider Service Standards
- Provider Qualifications
- Quality Assurance/Quality Control
- Test Chambers

* State and local agencies may have requirements in addition to NEHA's

S=Standard S/A=Standard & Analytical

Total found meeting search criteria: 37

CITY AND STATE OF RESIDENCE	NAME / STANDARD INFO	SERVICE TYPE	PHONE #
Bothell, WA	Patrick Thomas Moore Shaw Environmental, Inc.	S	(425) 402-3222
Mead WA	Sylvia J. Riddle	S	(509) 926-6217
		S	(509) 926-6217
	Advanced Radon Technologies, Inc.	S	(509) 326-5127
Spokane, WA	Mark S. Gerard Advanced Radon Tech, Inc.	S	(509) 326-5127
Spokane, WA	Chris Dixon Gold Seal Mechanical, Inc.	S	(509) 535-5944
Spokane, WA	Steven G Wilson Gold Seal Mechanical Inc.	S	(509) 535-5944
Wellpinit, WA	Twa-le Abrahamson Spokane Tribal Natural Resource	S	(509) 626-4403
	Scott Ackerman Ackerman Heating & Air Conditioning		
Hollister, CA	Bruce H. Howe Pacific West Property Inspections, Inc. dba House Master	S	(800) 995-4063

Wellpinit, WA

[Twa-le Abrahamson](#)
[Spokane Tribal Natural Resource](#)



Testing Protocols

- Short Term Test: 2-7 days
- Test in the lowest lived in room in your home
- You want to know what your family is actually being exposed to.
- Results fluctuate seasonally –retesting is recommended or consider long term tests

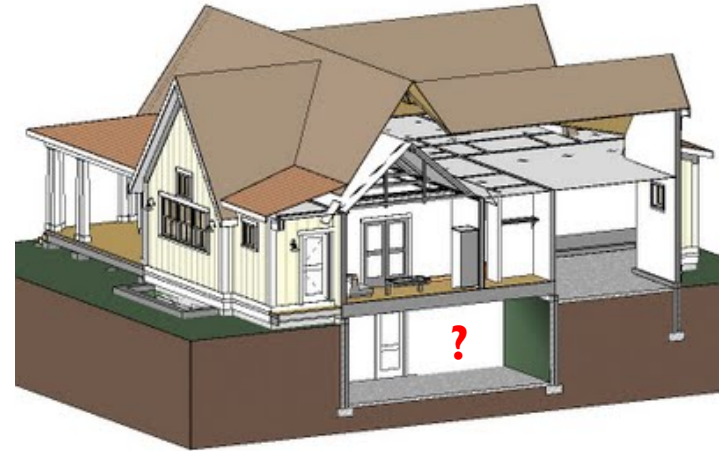

Which room?

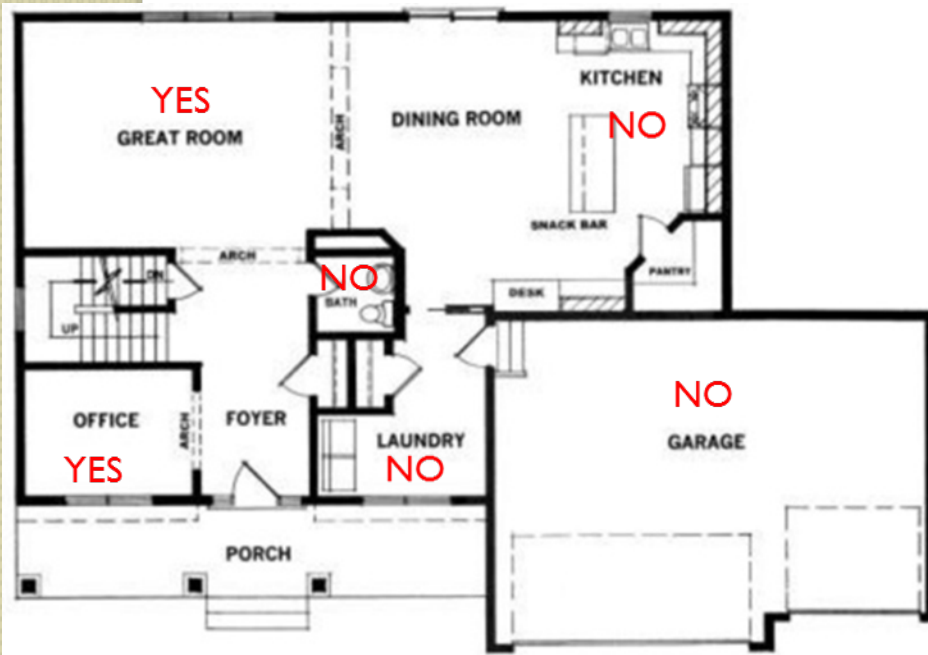

- In a room with low traffic, but frequently occupied (bedroom)
- Away from drafts
- Away from extreme heat and areas of high humidity.
- Avoid direct sunlight.

Location of Device in Room

- At least **20 inches** off the floor.
- Or hung, **6 to 8 feet** above the floor.
- More than **3 feet** from exterior doors, windows, or other openings to the outside.
- **12 inches** or more from an exterior wall.
- At least **4 inches** from other objects (including another test device)



Radon Measurement Devices

- Activated charcoal device
- Electret Ion Chamber (E-Perm)
- Continuous Radon Monitor



Activated Charcoal Devices

- For short-term tests
- Must be analyzed within 6 days
- Each device has its own test length



Advantages

- Compact, convenient and economical
- Can be used for 48-hour test
- Can be easily mailed to lab for analysis
- Passive, does not require power and silent
- Quick and accurate analysis

Disadvantages

- Limited to short-term sampling
- Provides no indication of changes (peaks and valleys) in radon during measurement.
- Hard to detect tampering

Activated Charcoal Devices

Electret Ion Chamber (E-Perm)

- Short-term and long-term measurements, measures radon in water with additional kit
- 2 days-1 year, dependent upon:
 - Configuration
 - Type of disk used
 - Anticipated radon concentration



Measuring Electret Voltages

- Electrets are pre-charged, can be reused.
- Electret voltages are measured and recorded before and after deployment.
- Math: (~ 2 volts drop per day per pCi/L)



Advantages

- Short-term and long-term measurements
- Electret can be re-used until voltage falls below 200 volts
- Can be recharged by manufacturer (\$15 each)

Disadvantages

- Sensitive to external gamma radiation. Correction needed.
- Sensitive to altitude changes. Correction needed.
- Can be damaged by touching surface, surface contamination or impact.
- Pre/post voltages must be measured at the same temperature.

Electret Ion Chambers

Continuous Radon Monitors

- Sun Nuclear (Solid State Silicon Detector)
 - Provides continuous measurements
 - Impacts from alpha particles are counted.
 - Data plotted and averaged
 - Relatively low efficiency
 - Used for diagnostics



Advantages

- Exposure variable: 48 hrs to many months
- Relatively good precision
- Can track hourly variations
- Options to download or print on site
- Can indicate tampering or ventilation.

Disadvantages

- Higher priced
- Requires trained operator
- Annual calibration
- Bi-annual performance tests.
- Can only test one room at a time.

Continuous Radon Monitors

Results from a CRM

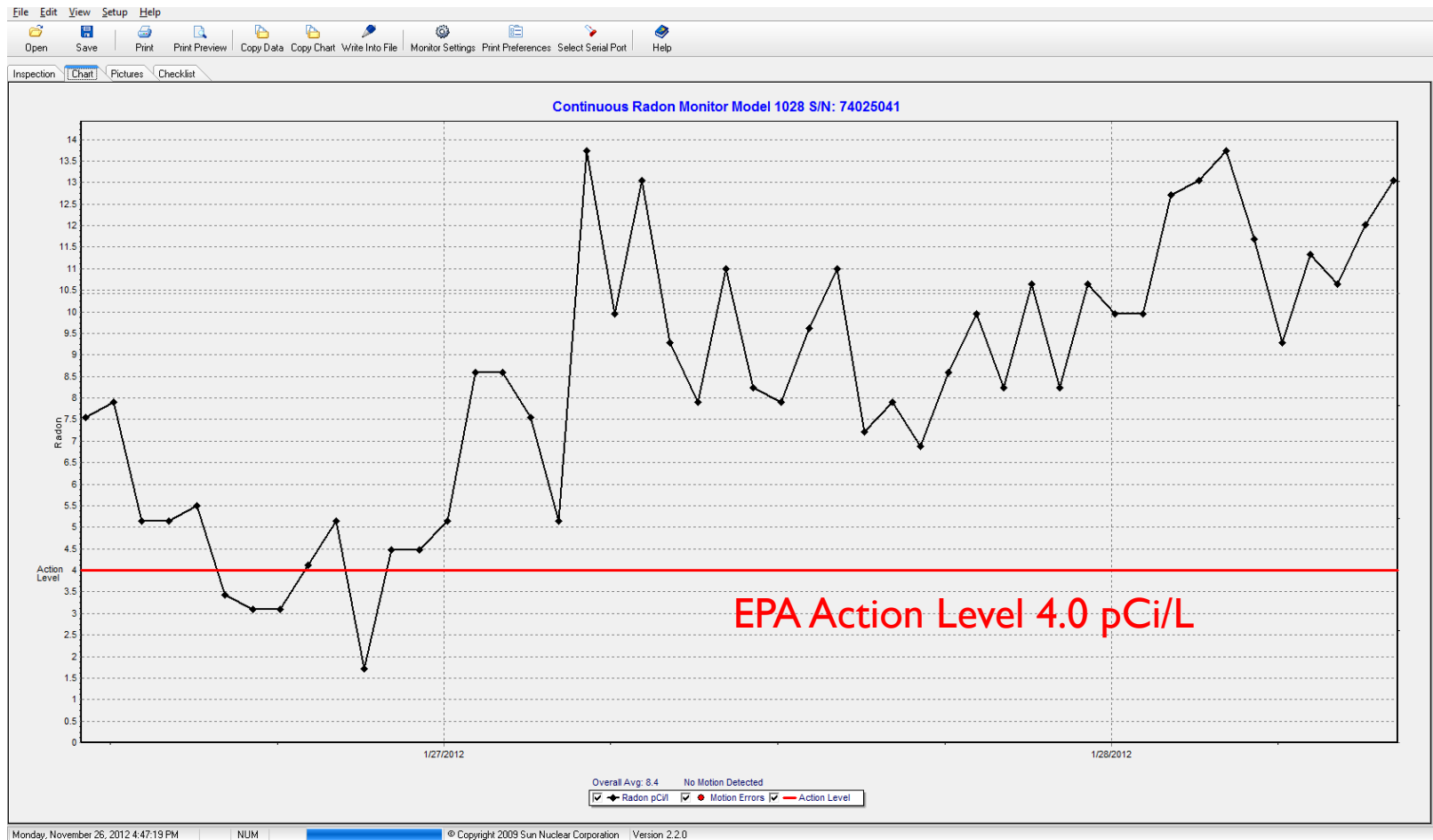

- My office in the Spokane Tribal Natural Resources Building
- Average 8.6 pCi/L, Highest Reading 13.7 pCi/L in the mornings about 4-7 AM
- Adjusted ventilation system and rates, used the building during mitigation training, now...just need some hands to install

Do It Yourself Test Kits

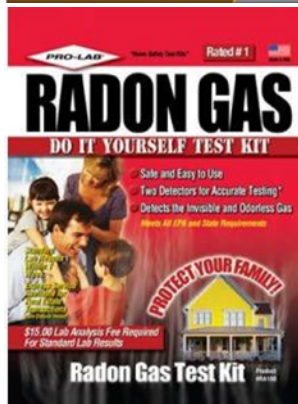
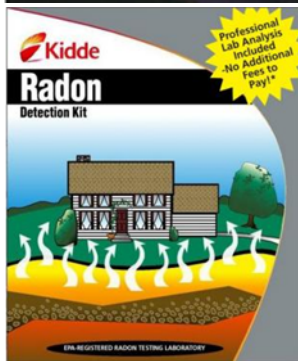

Walmart.com	“First Alert”	\$13.08 (Includes lab fee)
Lowes	“Kidde”	\$12.97 (Includes lab fee)
Home Depot	“Pro Lab”	\$9.98 for 2 (Does <u>not</u> include lab fee of \$30)
Ace Hardware	“Pro Lab”	\$11.99 for 2 (Does <u>not</u> include lab fee of \$30)

TIPS:

- Read and follow all included instructions
- Placement and shipping schedule are important
- Verify if lab fees are extra

Next steps...

Strategies to Address Structural, Institutional and Behavioral Issues

- 1) Test for Radon
 - Education and Outreach
- 2) Implement Radon Reduction Plans (Building Codes)
 - Education and outreach
- 3) Radon Mitigation
 - Education and outreach – construction staff, Housing staff

Radon Mitigation Training



Questions?

Twa-le Abrahamson-Swan
twalea@spokanetribe.com
(509) 626-4403



- www.epa.gov/radon
- www.sosradon.org